

EXISTING RETAIL PARK

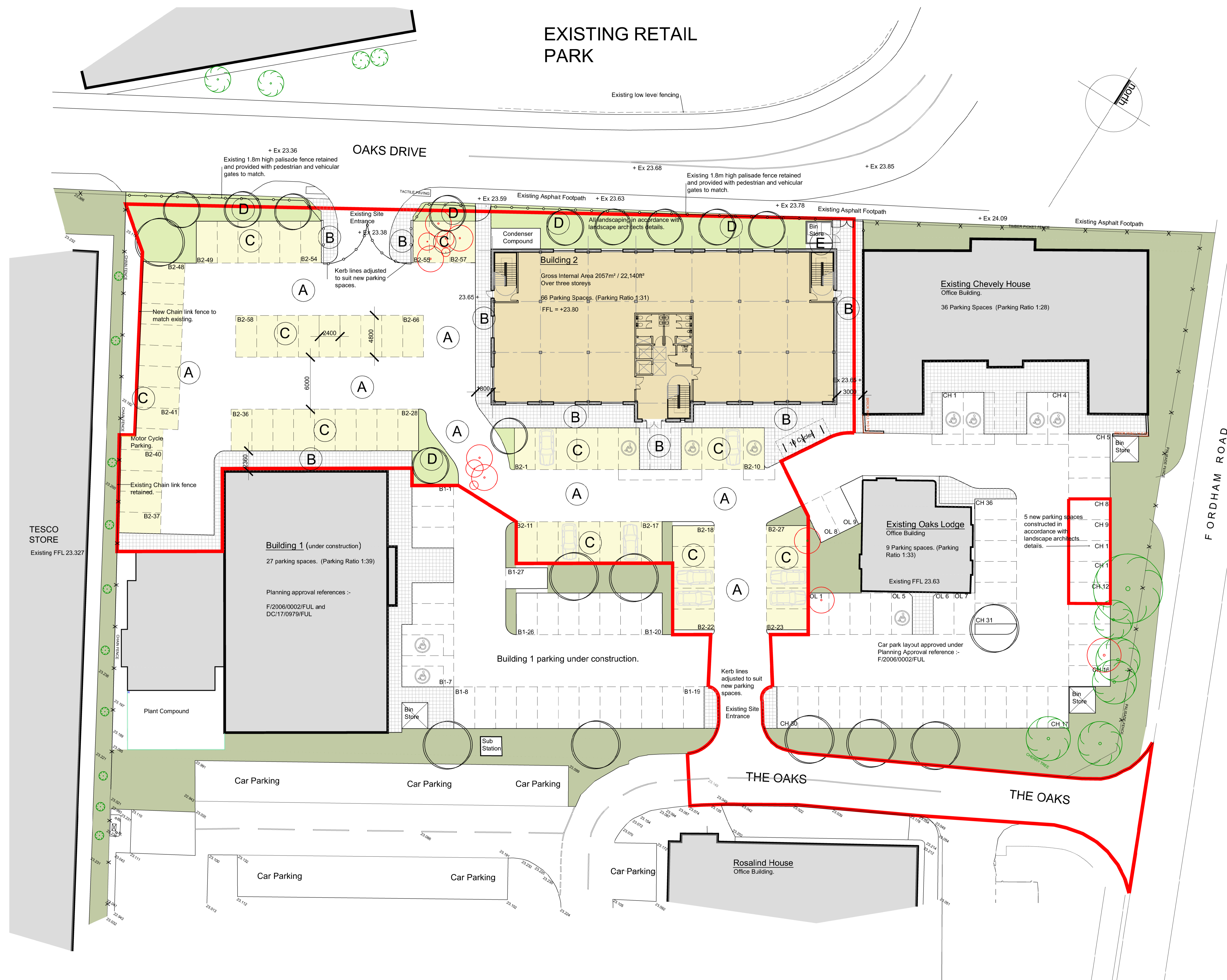

- Number
- Notes
- EXTERNAL FINISHES SCHEDULE**
- (A) INDICATES MARSHALLS BLOCK PAVIORS TO CAR PARK COLOUR: BRINDLE OR SIMILAR APPROVED.
 - (B) INDICATES PROPOSED MARSHALLS SAWN 400x400 PAVING SLABS COLOUR: NATURAL OR SIMILAR APPROVED.
 - (C) INDICATES MARSHALLS BLOCK PAVIORS TO CAR PARK BAYS COLOUR: CHARCOAL OR SIMILAR APPROVED.
 - (D) INDICATES PROPOSED SOFT LANDSCAPING
 - (E) GRAVEL MAINTENANCE FOOTPATH

- (●) INDICATES TREES REMOVED
- All landscape areas with application boundary to be carried out in accordance with landscape architects proposals. The Landscape Partnership drawing number B17073 / 101
- Car Parking spaces 2.4m x 4.8m to match the planning approved scheme under construction.
- APPLICATION BOUNDARY - 0.368H / 0.91ACRES**

AREA SCHEDULE
All Areas relate to Gross Internal Areas.

| | |
|--------------|---|
| Ground Floor | - 685.5m ² / 7378.5ft ² |
| Second Floor | - 685.5m ² / 7378.5ft ² |
| Third Floor | - 685.5m ² / 7378.5ft ² |
| TOTAL | - 2056.5m² / 22,135ft² |

| Rev | Description | Drawn | Date |
|-----|---|-------|----------|
| D | PLANNING APPLICATION | kdm | 16.02.18 |
| C | General amendments | kdm | 01.12.17 |
| B | Amendments to landscaping | kdm | 16.11.17 |
| A | Amendments to footpaths and security fencing added. | kdm | 20.10.17 |

MYHILL CONSULTING

Architecture & Development Consultancy

Holly Lodge, Holt Road, Wood Norton, Norfolk, NR20 5AY
T - 07740 409329 E - karl@myhillconsulting.co.uk

Status: **PLANNING**

Project Title: Building 2
The Oaks Newmarket

Drawing Title: Proposed Site Plan.

Scale: 1:200
Date: 10/10/17
Drawn: kdm
Number: 1702 / 02d